



**MOVME<sup>®</sup>**

**MAKE EVERYTHING EASIER**





00109Q1229RIM/3302  
00109E20323RIM/3302  
00109S10127RIM/3302



证书编号  
CNAS C001-Q. E. S



**AC**

**EPS**  
(Option)

# OPD15

The OPD15 is specially designed for Narrow aisles warehouse, it is most flexible, ergonomics and cost effectiveness.

## STANDARD FEATURES:

- Full AC control system.
- Finger-tips operation handle.
- Electric power steering (EPS) system.
- With electric magnetic multi-valve.
- Multi-function display , brake status, driving direction, hour meter, driving speed ,fault code etc.
- 48V -3 phase AC type with large capacity battery 1000Ah.
- With smallest Aisle width is 1650mm.
- Full suspension comfortable seat with belt is adjustable.
- Germany ZF brand gear box.
- Adjustable steering wheel.
- Sideway battery system.



Camera in three direction



Panel with big display



Wide view Mirros adjustable



Adjustable steering wheel



Conform to directive  
2006/42/EC-Machinery Directive(MD)  
2014/30/EU-Electromagnetic Compatibility Directive (EMC)

Model		OPD15
Drive: electric (battery type, mains, ...), diesel, petrol, fuel gas		Electric
Operator type: hand, pedestrian, standing, seated, order-picker		Seated
Rated capacity/rated load	Q (kg)	1500
Load center distance	c (mm)	600
Load distance,centre of drive axle to fork	x (mm)	150
Wheelbase	y (mm)	1840
Service weight	kg	6370
Axle loading,laden front/rear	kg	5800/2070
Axle loading,unladen front/rear	kg	3700/2670
Tyres: solid rubber, superelastic, pneumatic, polyurethane		Polyurethane
Tyre size,front	mm	Φ300x164
Tyre size ,rear	mm	Φ406x152
Wheels,number front/rear(X=driven wheels)		2/1X
Tread,front	b <sub>10</sub> (mm)	1360
Height,mast lowered	h <sub>1</sub> (mm)	2800/3200/3600/3800/4000/4300/4640
Free lift	h <sub>2</sub> (mm)	1330/1730/2130/2330/2530/2830/3170
	h <sub>2</sub> (*) (mm)	1700/2100/2500/2700/2900/3200/3540
Max.lift height	h <sub>3</sub> (mm)	5000/6200/7400/8000/8600/9500/10500
Height,mast extended	h <sub>4</sub> (mm)	5470/7670/8870/9470/10070/10970/11970
Height of overhead guard(cabin)	h <sub>6</sub> (mm)	2200
Seat height relating to SIP/stand height	h <sub>7</sub> (mm)	1120
Height of wheel arms	h <sub>8</sub> (mm)	320
Overall length	l <sub>1</sub> (mm)	3340
Length to face of forks	l <sub>2</sub> (mm)	3055
Overall width	b <sub>1</sub> /b <sub>2</sub> (mm)	1260/1520
Fork dimensions DIN ISO 2331	s/e/l (mm)	45/125/1250
Fork carriage ISO 2328,class/type A,B		2
Fork-carriage width	b <sub>3</sub> (mm)	880
Width across guide rolls	b <sub>6</sub> (mm)	1600
Reach,Lateral	b <sub>7</sub> (mm)	1300
Reach ,lateral from vehicle centreline	b <sub>8</sub> (mm)	495
Ground clearance,laden,below mast	m <sub>1</sub> (mm)	80
Ground clearance,centre of wheelbase	m <sub>2</sub> (mm)	80
Turning radius	Wa (mm)	2170
Distance to swivelling-fork pivot	l <sub>8</sub> (mm)	800
Travel speed,laden/unladen	km/h	8.0/8.5
Lift speed,laden/unladen	m/s	0.20/0.30
Lowering speed,laden/unladen	m/s	0.40/0.30
Reaching speed,laden/unladen	m/s	0.15/0.15
Service brake		Electromagnetic
Drive motor rating at S2 60min	kW	7.0(AC)
Lift motor rating at S3 15%	kW	12.0(AC)
Battery voltage/nominal capacity K5	(V)/(Ah) or kWh	48/1000
Battery weight	kg	1600
Sound pressure level at the driver' s seat	dB (A)	70

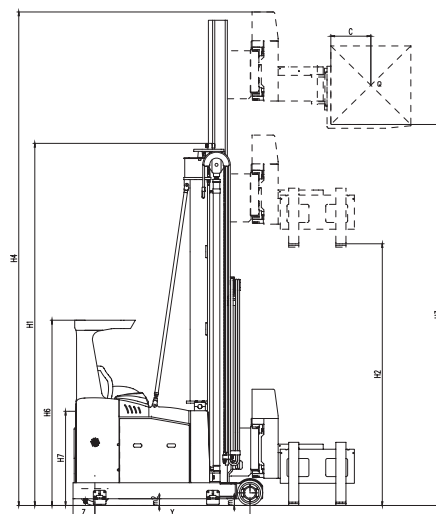
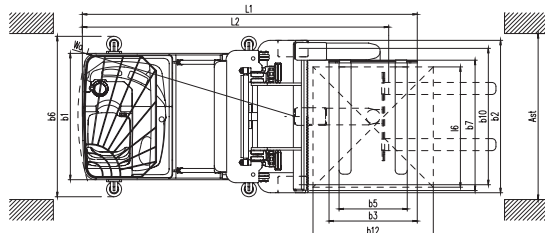
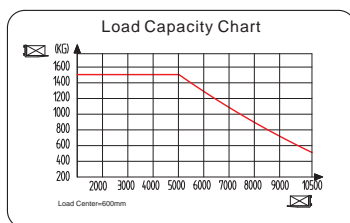



TEL: 0086-532-66739792

FAX: 0086-532-66739791

info@movmes.com

NO.88 Chunyang Road,Chengyang,

QINGDAO,CHINA

[www.movmes.com](http://www.movmes.com)